

ADTS554F

Wireless ADTS500 Series Easy-to-Use Pitot Static Testers

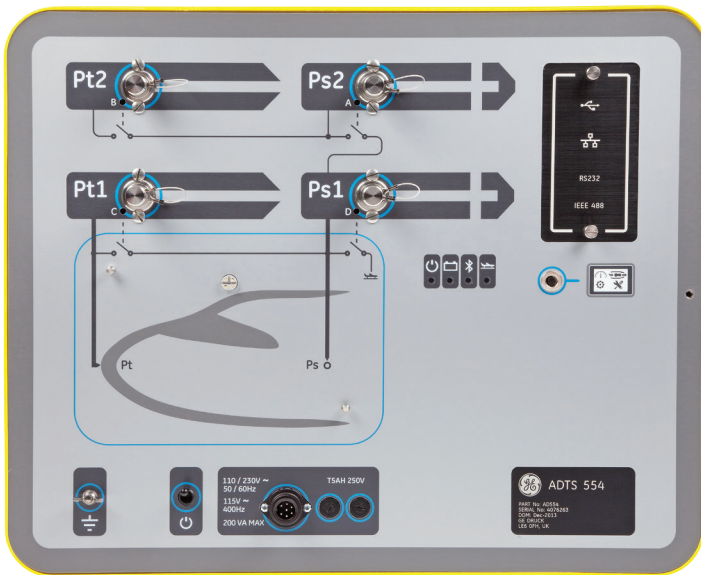

WiFi Bluetooth Swipe screen DRUCK technology 1-4 Multichannel



The ADTS554F air data test set is a portable four-channel flightline pitot static tester. In three-channel mode, it provides pitot static air data validation, leak testing, fault-finding and avionics instrumentation testing for any aircraft requiring angle of attack two off static-controlled channels, in addition to a pitot test channel. The ADTS554F can also be used as a standard two-channel flightline air data test set or two simultaneous two-channel air data test sets.

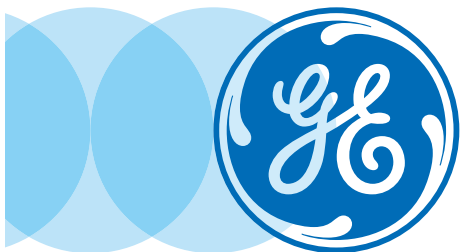

www.ge-mcs.com

© 2014 General Electric Company. All Rights Reserved. Specifications subject to change without prior notice. Other company or product names mentioned in this document may be trademarks or registered trademarks of their respective companies, which are not affiliated with GE. The Bluetooth® word mark and logos are registered trademarks owned by Bluetooth SIG, Inc. and any use of such marks by GE is under license.



ADTS554F at a glance

- ADTS Touch hand terminal with Bluetooth® wireless technology (backup cable supplied)
- Swipe-action touch screen user interface with the colour graphics and menu
- Uses standard icons and layouts for routine testing
- Can be used as two-, three- or four-channel air data test set
- Multiple languages
- High flow proportional pressure control technology
- Low airspeed option
- TERPS high accuracy pressure sensors inside
- Accuracy suitable for RVSM validation
- 15-month calibration interval for low cost of ownership
- Optional 18-month calibration interval for increased savings on the cost of ownership
- Battery backup option
- Engine Pressure Ratio option
- Stores customized aircraft test sequences
- Large capacity pressure/vacuum pump
- A minimum of 5,000 pump running hours
- Optional second slave ADTS Touch hand terminal
- Accessories bag
- Optional accessories: ADTS Touch carry case, hoses and adaptors
- GE ADTS global service support
- 24-month warranty period